

BINGHAM COUNTY COMMISSIONERS

Whitney Manwaring, Chairman

Mark R. Bair

Eric Jackson



Lindsey Dalley, Commission Clerk
501 N. Maple Room 204
Blackfoot, ID 83221
Phone (208) 782-3013
Fax (208) 785-4131

Wednesday, April 24, 2024

- | | | |
|------------|--|---------------|
| 8:15 a.m. | Approval of Cash Warrants, Claims & Administrative Documents. | {ACTION ITEM} |
| 8:30 a.m. | Weekly update meeting with Sheriff Jeff Gardner. | |
| 9:00 a.m. | Weekly update meeting with Dusty Whited- Public Works Director. | |
| 9:00 a.m. | Discussion & decision to change the cluster mailbox requirement for new subdivisions to include a paved turnout & sign detail. | {ACTION ITEM} |
| 9:00 a.m. | Decision regarding the request from Fire Chief Randy Adams, to have the county haul fill to the project site for the Firth Fire Station. | {ACTION ITEM} |
| 10:00 a.m. | Discussion regarding security, vulnerability and penetration testing On the network- Requested by Matt Galloway- IT Director. | |
| 11:00 a.m. | Meeting with Tim Solomon- Rocky Mountain Power, to discuss a Community Performance Plan for 2024. | |
| 6:00 p.m. | Youth Court- Commissioners May Attend. | |
| 6:00 p.m. | Open House regarding the McTucker Boat Ramp Proposal- held at 1345 Barton Road, Pocatello- Commissioners may attend. | |

“Potato Capital”



CLUSTER MAILBOX DETAILS

NO SCALE

NEW CONCRETE BASE:

- 1) The new concrete base shall be placed on a minimum of 4 inches of 3/4 inch compacted road base.
- 2) Refer to Table 1 for thickness (h), width (w), and depth (d) of the concrete pad alternatives.
- 3) Concrete shall have a compressive strength of 3000 psi @ 28 days, contain 4% min ~ 6% max air entrapment and be placed with a 3.50~4.50 slump.
- 4) Use standard concrete wire mesh or fiber reinforced concrete.

EXISTING CONCRETE BASE:

- 1) Existing concrete pad must be at least 48" wide.
- 2) Concrete base and anchor bolts may be reused if:
 - a. existing 1/2" diameter expansion anchor bolts are firmly embedded in the concrete and not damaged or corroded;
 - b. concrete foundation is not damaged; and
 - c. bolt hole pattern of the new unit matches the installed anchor bolts.
- 3) Additional considerations include:
 - a. if concrete is only 4" thick, then option 'b' in Table 2 below cannot be used
 - b. any unused, existing anchor bolts must be cut flush to the level of the concrete surface
 - c. if concrete is damaged, replacement of foundation pad is required

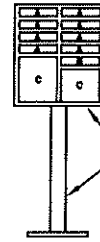

MODEL #3308
TYPE I MULTI-SIZE
COMPARTMENT CBU
W/OUTGOING MAIL SLOT
LOCATED IN DOOR "B"
(MANUFACTURED BY
WWW.MAILBOXES.COM
OR APPROVED EQUAL)

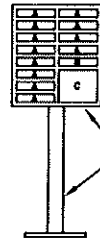

MODEL #3312
TYPE II MULTI-SIZE
COMPARTMENT CBU
W/OUTGOING MAIL SLOT
LOCATED IN DOOR "B"
(MANUFACTURED BY
SALSBURY INDUSTRIES
OR APPROVED EQUAL)

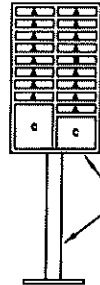

MODEL #3316
TYPE III MULTI-SIZE
COMPARTMENT CBU
W/OUTGOING MAIL SLOT
LOCATED IN DOOR "B"
(MANUFACTURED BY
WWW.MAILBOXES.COM
OR APPROVED EQUAL)

TABLE 1: Pad Recommendations

h (Thickness)	w (Width) min	d (Depth) min
4"	47"	47"
5"	44"	44"
6"	42"	42"
7"	40"	40"
8"	39"	39"

TABLE 2

Expansion Anchor Bolt Recommendations (or equivalent)
a. Hilti Kwik Bolt II (www.hilti.com) - 1/2 inch diameter x 5 1/2 inches overall length - Galvanized - KB II 12-512, Stainless Steel Minimum embedment in concrete must be at least 3 1/2 inches
b. ITW Ramset Redhead Turbolt (www.hilti.com) - 1/2 inch diameter x 7 inches overall length - Galvanized Minimum embedment in concrete must be at least 4 1/8 inches
c. Rawl Stud (www.rawl.com) - 1/2 inch diameter x 5 1/2 inches overall length - Galvanized Minimum embedment in concrete must be at least 4 inches

3M HIP, EC 1177 GREEN & EC 1175 BLUE or if printed on 3M approved printer, must have 3M 1170 UV overlay. Also must carry 3M's warranties of 10 years for reflectivity and fade.

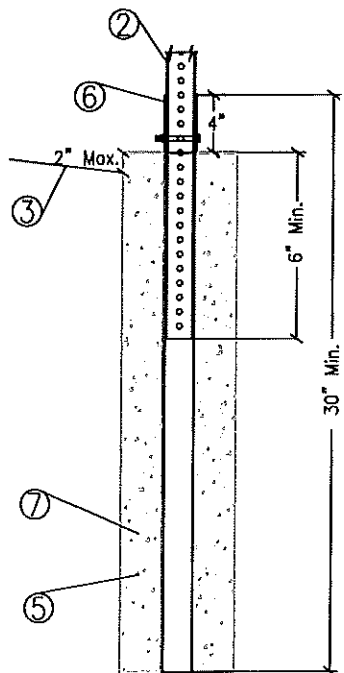
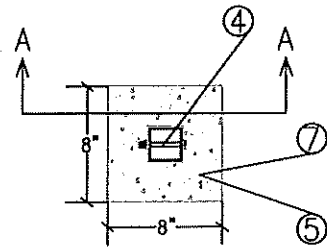
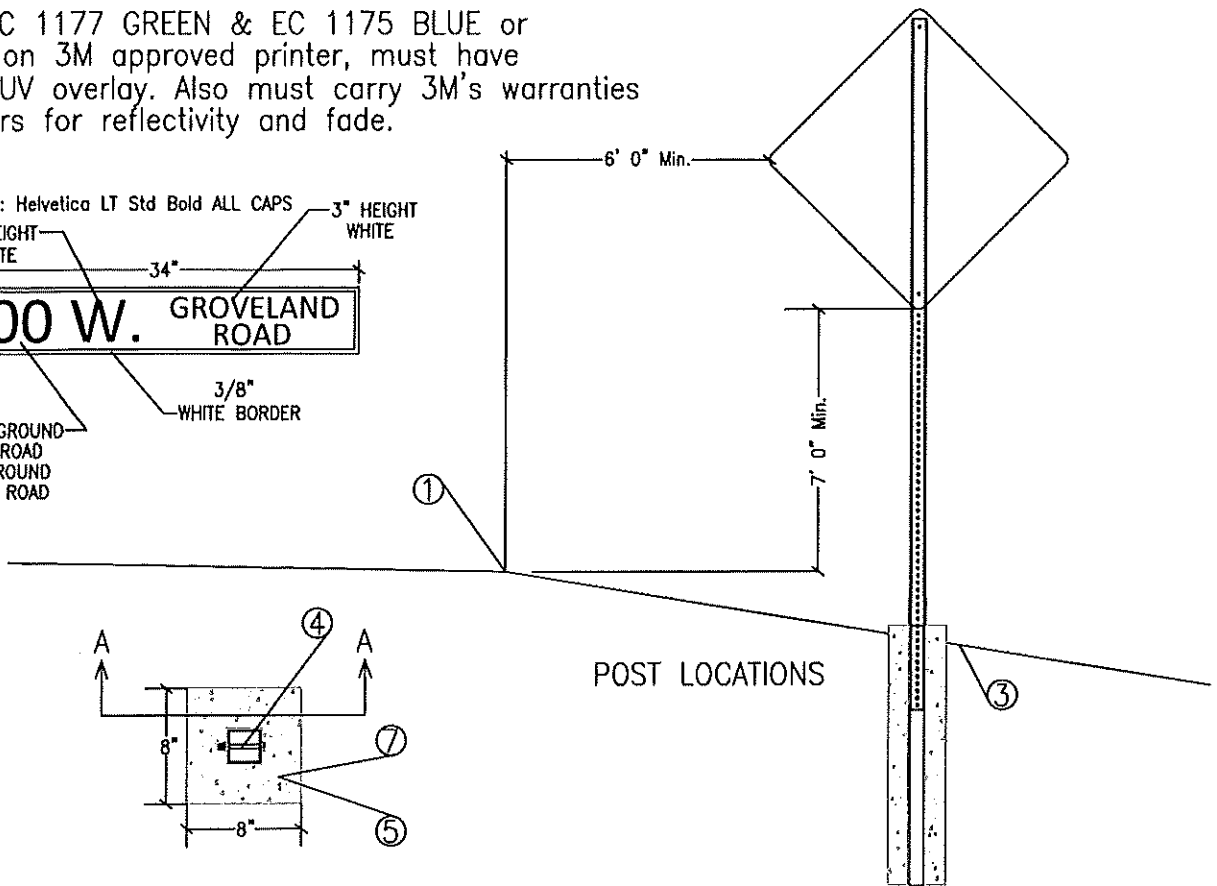
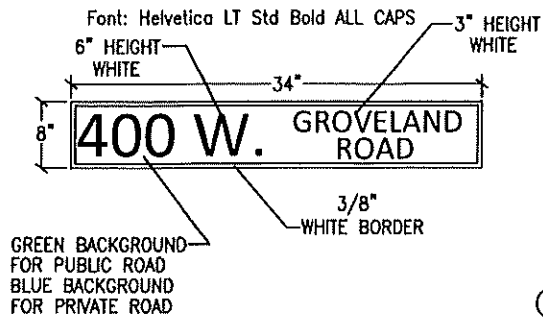

SECTION AA

LEGEND

- 1 NORMAL SHOULDER LOCATION
- 2 2" X 2" PERFORATED SQUARE TUBING. 14 GAUGE WALL THICKNESS
- 3 GROUND LINE
- 4 3/8" X 3" HEX HEAD BOLT W/ LOCKNUT & 2 FLAT WASHERS
- 5 CLASS 3000 psi CONCRETE
- 6 2 1/4" X 2 1/4" X 30" PERFORATED SQUARE TUBING 12 GAUGE WALL THICKNESS
- 7 12" DIA. CIRCULAR CONCRETE FOUNDATION X 26" DEPTH OR 8" X 8" X 26' MAY BE USED

SIGN POST INSTALLATION DETAILS
 WITH PRECAST OR CAST IN PLACE ANCHOR POST



MAILBOX TURNOUT (RURAL & SUBDIVISION)

RIGHT OF WAY LINE

DIRECTION OF TRAVEL

EDGE OF TRAVELED WAY

DIRECTION OF TRAVEL

4:1 TAPER

32'

8'

15'

2.5:1 TAPER

20'

PAVED IF WITHIN SUBDIVISIONS
GRAVEL IF ALONG RURAL ROADWAY

MAILBOXES

FOR NEW SUBDIVISION AND RURAL MAILBOX INSTALLATION

Meeting Date: April 24, 2024
Meeting Time: 9:00 am



REQUEST FOR MEETING WITH BINGHAM COUNTY COMMISSIONERS FORM

The Board of County Commissioner's hold meetings various days throughout the week, which are coordinated with the Commission Clerk. Per Idaho Code §74-204(1), the Board cannot hold a meeting without less than 48 hours' notice and posting on the Commission Agenda. Any person(s) needing special accommodations should contact the Lindsey Dalley, Commission Clerk, at (208)785-3013.

Name: Chief Randy Adams Email: shelley fire chief@gmail.com
Phone Number: 208-521-5501 Address: 585 W Fir, Shelley, ID

1. What is the topic of discussion that you wish the Board to have?
To discuss bringing fill into the new Firth fire station
build site supplied by the county.

2. Approximately how much time will you need for this agenda item?

15 minutes

3. Will you be requesting that the Board make a decision?

Yes

4. Have all supporting documents been included with this form? If not, please note that your meeting may not be scheduled until all necessary documentation has been provided to the Commission Clerk.

n/a

5. Please provide the name and contact information of the individuals that you would like to be invited to the meeting. (Include name, telephone number and email address if known)

Dusty W - Road + Bridge 208-380-9606

Please hand deliver or email this completed form, along with all supporting documents to Lindsey Dalley at Ldalley@binghamid.gov, at least 24 hours prior to your scheduled meeting time.

Meeting Date: April 24, 2024
Meeting Time: 10:00 am



REQUEST FOR MEETING WITH BINGHAM COUNTY COMMISSIONERS FORM

The Board of County Commissioner's hold meetings various days throughout the week, which are coordinated with the Commission Clerk. Per Idaho Code §74-204(1), the Board cannot hold a meeting without less than 48 hours' notice and posting on the Commission Agenda. Any person(s) needing special accommodations should contact the Lindsey Dalley, Commission Clerk, at (208)785-3013.

Name: **Matthew Galloway**

Email: **mgalloway@binghamid.gov**

Phone Number: **208-782-3061**

Address:

1. What is the topic of discussion that you wish the Board to have?

Discuss security, vulnerability, and penetration testing of the network.

2. Approximately how much time will you need for this agenda item?

15 min

3. Will you be requesting that the Board make a decision?

No

4. Have all supporting documents been included with this form? If not, please note that your meeting may not be scheduled until all necessary documentation has been provided to the Commission Clerk.

5. Please provide the name and contact information of the individuals that you would like to be invited to the meeting. (Include name, telephone number and email address if known)

Please hand deliver or email this completed form, along with all supporting documents to Lindsey Dalley at Ldalley@binghamid.gov, at least 24 hours prior to your scheduled meeting time.